



SUPRA 7 - MECHANISM WITH OFFSET HANDLE

Functions

Innovative reversible mechanism system without washer, which can be used for moving window sashes with different types of opening, having mechanisms compatible with 7 mm square pins.

Version in which the square spindle and the mechanism are supplied separately, so the MECHANISM + the FIXING KIT are needed to create a SUPRA 7.

Online data sheet



Technical Features

The Supra 7 window handles can be combined with the Giesse sash, Tilt-and-turn, Side Hung, Top Hung and Sliding movements and mechanisms which have a rotor with a 7 mm square slot.

The mechanism / movement must be firmly and independently fixed to the sash profile and receive the motion from the 7 mm pin of the Supra 7 window handle.

The machining to be carried out on the sash profile is simple and fast and Giesse has created 2 drilling templates to facilitate the operations (art. 03546 and art. 03547).

The product application takes place in 2 steps: first of all the base is fixed, with the integrated 7 mm pin, to the sash profile by means of the 4 TORX screws and then, after having pressed the handle firmly on the base, the pre-assembled grub screw is completed screwed onto the handle.

The supply includes 2 snap disks to be chosen based on the geometry of the sash profile.

The 7 mm square pin protrudes from the window handle support plane of 45 mm.

On request the length of the pin can be changed.

Materials

Handle in die-cast aluminium

Internal components made of GS SILVER PLUS

zamak, zinc plated steel and white polyamide

Zinc plated steel fixing screws, with Eslock treatment

Fixing with 45° or 90° machining

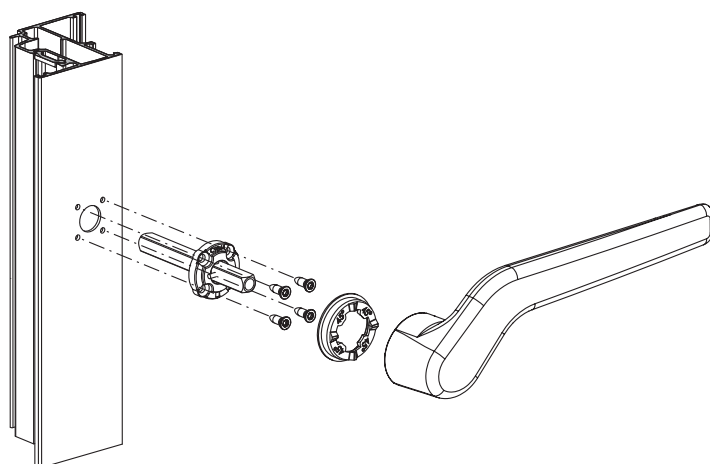
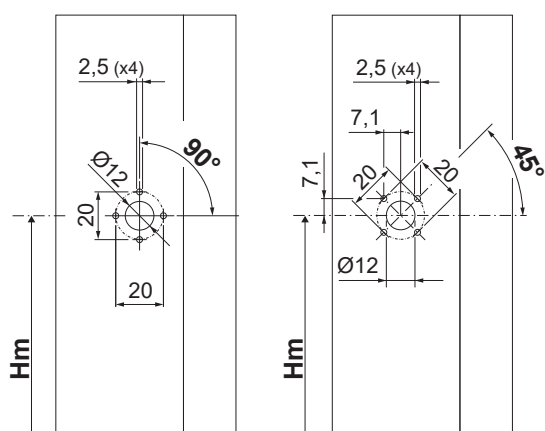

052621

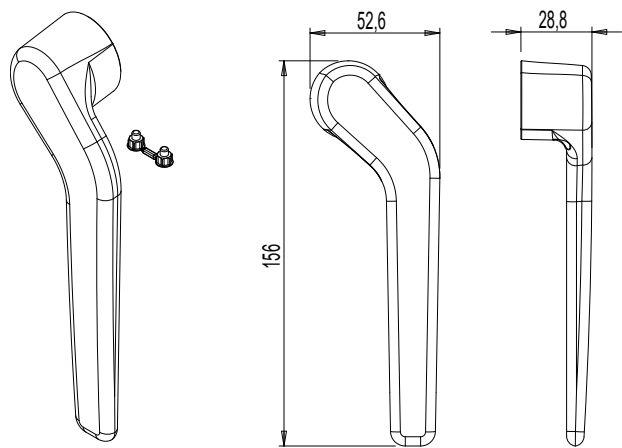

052622

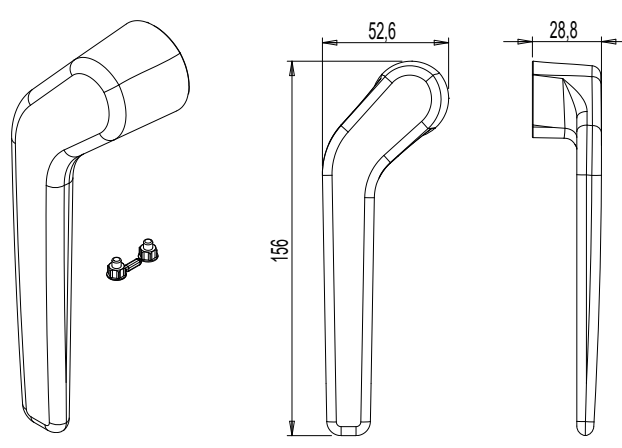

05560

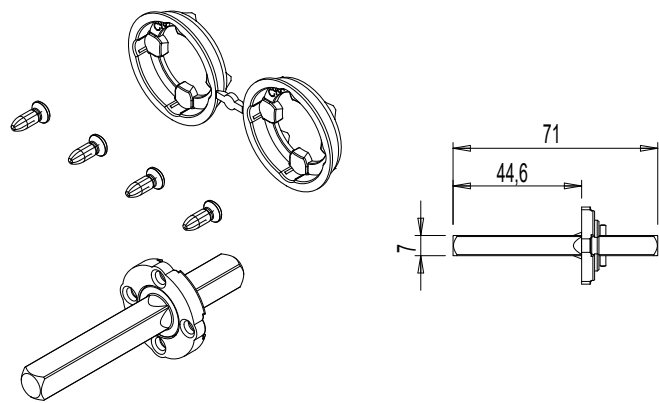

05261

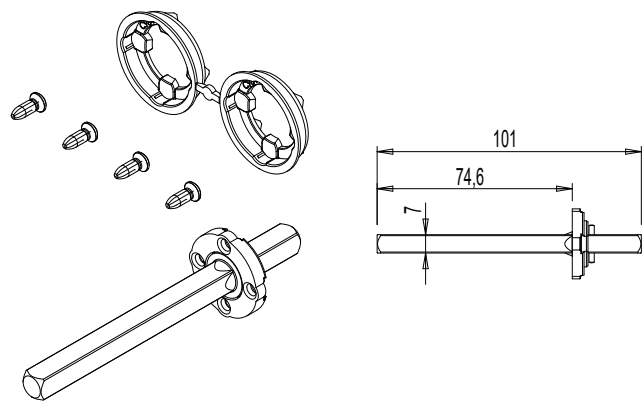

Item code	Description	Notes	Square spindle length [mm]	Base Raw	Anodised Elox	Painted	Trend/Gold Brass	Pieces per pack
052621	SUPRA 7-OFFSET MECHANISM	RX		X		X		10
052622	SUPRA 7-OFFSET MECHANISM	LX		X		X		10
05560	SUPRA 7 - FIXING KIT		71	X				10
05261	SUPRA 7 - FIXING KIT		101	X				10