

GS3000-300 PULLEYS



Functions

Reversible pulleys for GS3000 lift and slide system.

Online data sheet



Technical features

Reversible two-wheel pulleys with lever type lifting device, to create operable sashes from 300 to 400 kg.

Pulleys 300/22

Set composed of a primary corner pulley, equipped with a toggle for sash lifting, and a secondary pulley.

Connection and drive of the secondary pulley occurs by means of a connection rod to be cut to length.

Compatible with drive gear with 27.5 and 37.5 mm backset and with window handles having 80 mm fixing C/C distance.

Complete with threaded bushings to fit on the drive gear for use with a single handle and in the external handle, for use of a double handle.

300/22 additional pulley

Additional pulley, to combine with the 300/22 pulleys in the following cases:

- 1 additional pulley for sashes wider than 2500 mm and up to 300 kg
- 2 additional pulleys for sashes up to 400 kg with width >1300 mm

Connection to the other pulleys by means of the length of connection rod supplied.

The 300/22 pulleys and 300/22 additional pulley feature a wheel that is compatible with 2.5 mm radius rails.

Both equipped with special support components that keep the wheels raised from the track in the sash closed position.

Supplied complete with fixing screws, connection rod pin and rod guide.

Connection rods

The connection rod transmits drive from the main pulley to the secondary pulley.

Available in three different sizes, to be cut in accordance with the sash width. Compatible with all pulley versions.

Capacities

For sashes up to 400 kg.

Materials

Pulley body in galvanised zamak

Stainless steel side covers

Stainless steel levers, connecting brackets and pins

Fibreglass-reinforced nylon wheels

Connection rod in zinc plated steel

Connection rod guides in fibreglass-reinforced nylon

Fixing screws, zinc-coated steel

Zinc plated steel bushings

Pulley support components in nylon

Pulleys connection rod in zinc plated steel

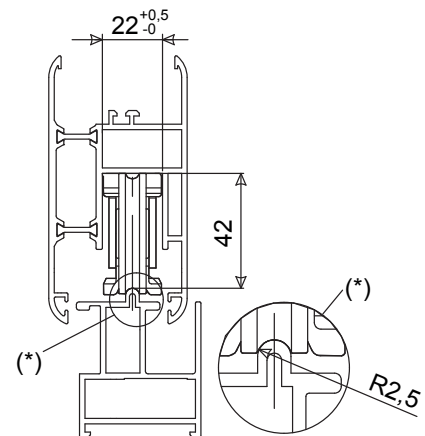

Pulleys 300/22

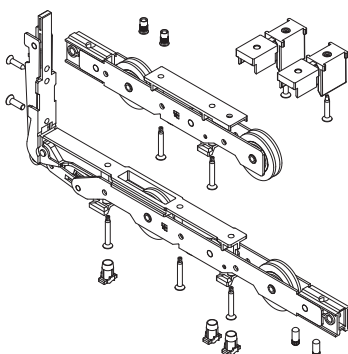

300/22 additional pulley

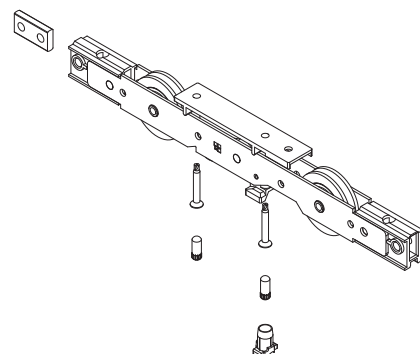

Art. 07101

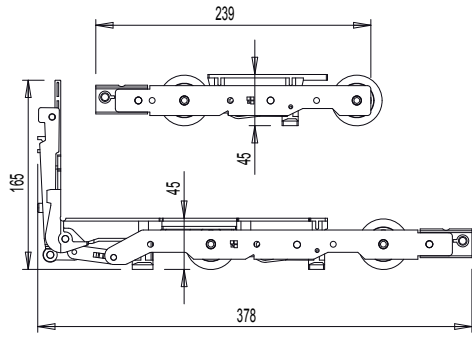

Art. 07102

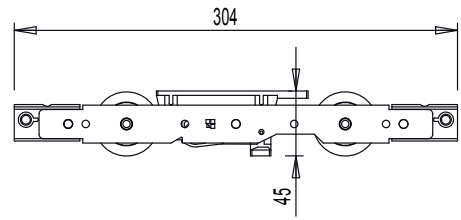

Standard assembly

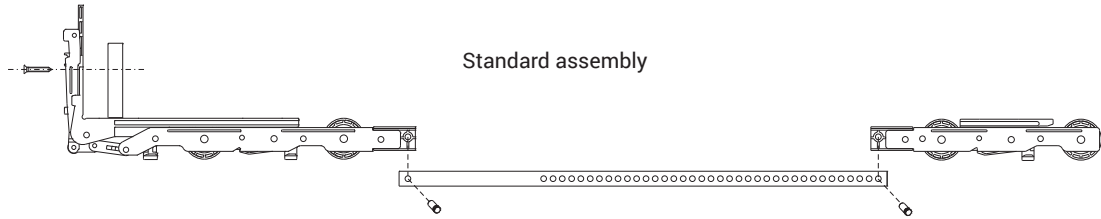

Assembly with 1 additional pulley (300 kg)

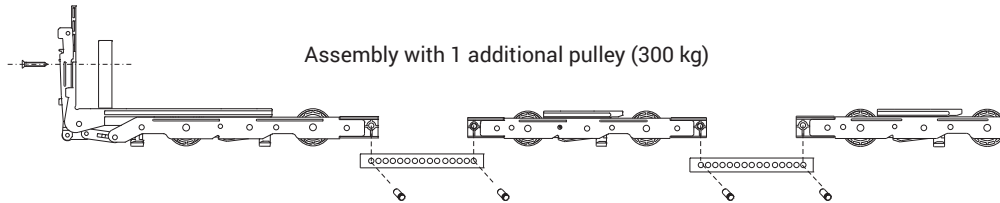

Assembly with 2 additional pulleys (400 kg)

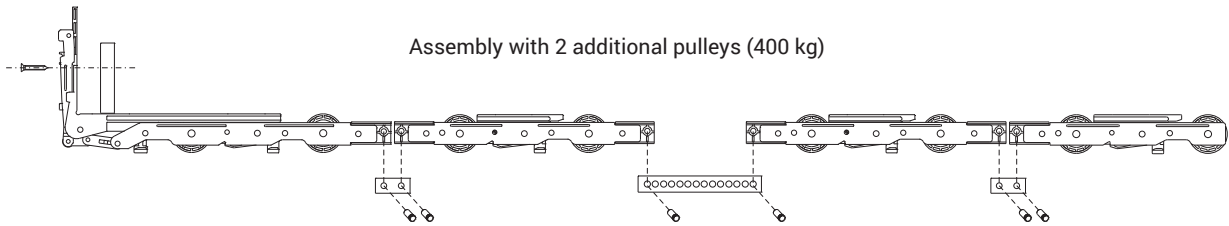

Pulleys connection rod

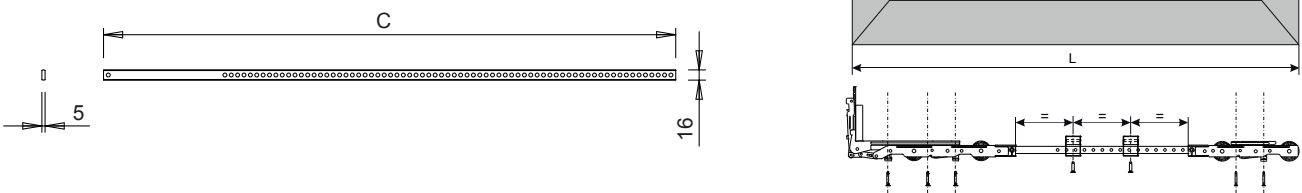

Item code	Description	Slot width (A)	Track height (B)	Max sash weight	Compatible with drive gear	Compatible with window handle C/C distance (I)	Base Raw	Anodised Elox	Painted	Trend/Gold Brass	Pieces per pack
07101	300/22 PULLEYS - GS3000	22 mm	42 mm	300 kg	E = 27.5 E = 37.5	80 mm	X				1
07102	ADDITIONAL PULLEY 300/22-GS3000	22 mm	42 mm	300 kg with 1 pulley 400 kg with 2 pulleys	E = 27.5 mm E = 37.5 mm	80 mm	X				1

Item code	Description	Rod length (C)	Sash width (L) (*)	Base Raw	Anodised Elox	Painted	Trend/Gold Brass	Pieces per pack
07146	PULLEYS CONNECTION ROD 900 - GS3000	900 mm	600 - 1500 mm	X				5
07147	PULLEYS CONNECTION ROD 1400 - GS3000	1400 mm	1501 - 2000 mm	X				5
07148	PULLEYS CONNECTION ROD 1900 - GS3000	1900 mm	2001 - 2500 mm	X				5

(*) the dimensions are referred to the minimum and maximum sash width that can be constructed with the selected rod. When using additional pulleys the maximum permissible sash width is 3350 mm.